



Storage, Handling, Fastening & Installation Guidelines



Cut. Fasten. Paint. Admire.



Follow us on
Instagram

@DurationMouldingandMillwork

DURATIONMillwork.com

888-388-7852

info@durationmillwork.com

The following information offers typical installation techniques when working with DURATION® Trim & Siding. These products should never be used in structural or load bearing applications. These directions are guidelines only. As with installing any building material, care should be taken to adhere to local code requirements and construction best practices, to ensure installation is sufficient for each specific application.

STORAGE & HANDLING

For expected performance results, ensure the product is completely dry and clean when fastened to the wall. For proper paint adhesion, the product should be dry and clean before painting.

- DURATION® Trim & Siding should be stored on a flat, level surface in a clean, dry location.
- Keep product wrapped and protected from the elements until ready for installation.
- Installing product wet or saturated may result in gapping at joint locations.

GAPPING DOES NOT CONSTITUTE A PRODUCT DEFECT.

WORKING with DURATION® SIDING & TRIM

This product is an excellent replacement for wood trim and siding and can be installed using proven woodworking tools and methods. For ease of use, consider the following before working:

Safety - In working with any product that may cause airborne debris such as a nuisance dust, be sure to take proper measures to protect against inhalation and eye contact

Cutting - DURATION® Trim & Siding can be cut using standard carbide-tipped blades, with those blades subsequently being “dedicated” to poly-ash, i.e. only used to cut poly-ash moving forward – a single cut made into wood after cutting poly-ash will render the blade ineffective. A carbide-tipped blade previously used for wood only *can* be used for poly-ash, but once used on poly-ash, the blade must be dedicated to poly-ash.

Routing & Drilling - DURATION® Trim & Siding can be drilled and routed using standard woodworking tools, but carbide-tipped router and drill bits are recommended and should be dedicated.

Caulks & Sealants - While DURATION® Trim & Siding does not require priming or sealing of end-cuts, a variety of caulks and sealants may be used in conjunction with the product to help prevent water intrusion into the structure.

Gluing - Although not necessary, DURATION® items can be field glued using a polyurethane adhesive like PL® Premium or Titebond® Polyurethane glue. Be careful not to get polyurethane adhesive on surfaces that will eventually be painted as paint does not readily adhere to polyurethane adhesive. Alternatively, DURATION® does offer its proprietary epoxy system for specific installations requiring such an adhesive. Please note that DURATION® does NOT recommend attempting lamination of the product in the field given the need for specific surface preparation and significant pressure clamping.

Expansion and Contraction - DURATION® Trim & Siding is very stable during periods of temperature and exposure to moisture; all ends can be placed tight to adjoining end. No special precautions, such as, gluing or gapping are necessary to control or limit movement. Minor shrinkage at board ends is not considered a defect.

Nail Holes & Repair - Filling nail and screw holes or repairing any minor damage caused by handling may be done using high-grade exterior acrylic caulk or wood filler. We strongly recommend Elmer’s ProBond® professional strength wood filler.

Use at Grade - Since DURATION® Trim & Siding will not rot and is highly resistant to any type of insect infestation, it is approved for ground contact.

Painting - Painting DURATION® Trim & Siding is a requirement, and failure to do so will void the warranty. As in preparing for any painting project, be sure the surface of the product is free of dirt, debris, or other contaminants prior to paint application.

PRIMING OF POLY-ASH IS NOT A REQUIREMENT BEFORE PAINTING.

- Use any high-grade exterior paint. Make sure to follow the paint manufacturer's application recommendations.
- Apply any color regardless of darkness or light reflectance value.
- No need to prime or seal faces, end-cut or field-cut edges.
- Paint should be applied within 12 months of installation.

FASTENING GUIDELINES

Fastening - Standard nail guns and screws can be used to install DURATION® Trim & Siding as it takes a variety of fasteners with ease and does not mushroom at the fastener head.

- Ensure the product is completely dry and clean before fastening to the wall.
- Use fasteners designated for exterior trim and siding.
- Pre-drilling is not required.
- **When face nailing product that has the smooth, subtle TruExterior® grain, we highly recommend use of the "Painter's Tape" system to minimize the fill and sanding area; this results in an inconspicuous fill area and preservation of the subtle, vertical grain of the material – See section at end of instructions.**

For Trim and Moulding Applications

- Fasteners should be installed every 24" OC or less. For best results, place fasteners within 2" of the edge of each piece.
- Optimally, butt joints should be cut at 30° to 45° degree angles.

For 2x Applications

- Use a fastener that is long enough to penetrate a solid wood substrate a minimum of 1-1/2".
- Fasteners should penetrate a framing member. Sheathing alone may not provide adequate support or holding power.

Non-Beveled Siding (e.g. Shiplap, Channel, Nickel Gap, etc.)

- Install a drainable housewrap that allows water that gets around siding to drain out through the bottom of the system. We highly recommend HydroGap® by Benjamin Obdyke. Flashing behind vertical joints can be omitted with the use of an effective drainable housewrap.
- Use of 8d x 2-1/2" stainless steel, ringed shank nails is recommended to meet the wind load and performance results stated in the ES report PER-13069.
- Use 2 fasteners per every framing member.
- At least one fastener should be run through the face of the profile, simply fastening the product through a tongue or shiplap is not sufficient.
- Fasteners should be installed every 16" - 24" OC or less to meet the performance results stated in the ES report PER-13069. For best results, place fasteners within 2" of the edge of each board.
- Use a fastener that is long enough to penetrate a solid wood substrate a minimum of 1-1/2".
- Fasteners should penetrate a framing member. Sheathing alone may not provide adequate support or holding power.
- Standard nail guns can be used to install DURATION® Siding. Nail guns should be adjusted to ensure nail head is flush or slightly below the surface.
- Profiles can be installed both horizontally and vertically. Make sure to adhere to local building codes to ensure that wind load or other fastening requirements are met. For vertical applications, make sure sufficient horizontal blocking is properly installed.

Beveled Siding

- DURATION® beveled siding must be installed on frame-built walls with studs spaced 16" on center, or at most, 24" on center.
- The wall must be sheathed with O.S.B. or plywood panels per local code
- Install a drainable housewrap that allows water that gets around siding to drain out through the bottom of the system. We highly recommend HydroGap® by Benjamin Obdyke. Flashing behind vertical joints can be omitted with the use of an effective drainable housewrap.
- DURATION siding must be fastened at the location of the studs.
- Two fasteners are required within 2" of a joint on each side of a joint - one fastener at the top of each board and one fastener in the face of each board.
- Use of minimum 6d stainless steel, ring shank nails are recommended to meet the wind load and performance results stated in the ES report PER-13069.
- Minimum overlap of boards per course is 1", with 1-1/4" being common. Boards may be overlapped at any dimension 1" or greater without affecting performance.
- The product will accept other types of fasteners including various types of exterior grade nails and screws. Care should be taken to ensure both fastener type and fastening pattern will meet local code requirements and performance needs.
- Standard nail guns can be used to install DURATION® Siding. Nail guns should be adjusted to ensure nail heads are flush with or just slightly below the exterior surface. Do not over drive fasteners.

Acceptable Wall Preparation & Fastening Patterns for Beveled Siding

Figure 1: Blind Nailing

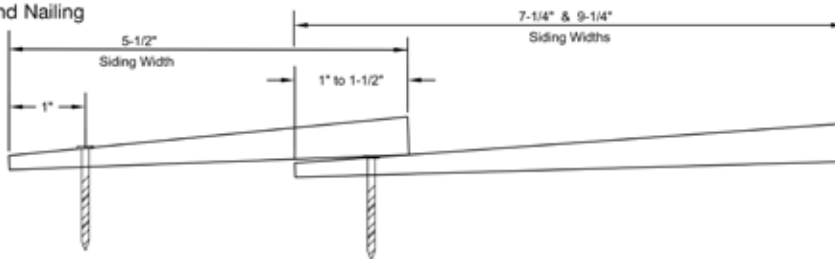

Figure 2: Face Nailing, Option 1

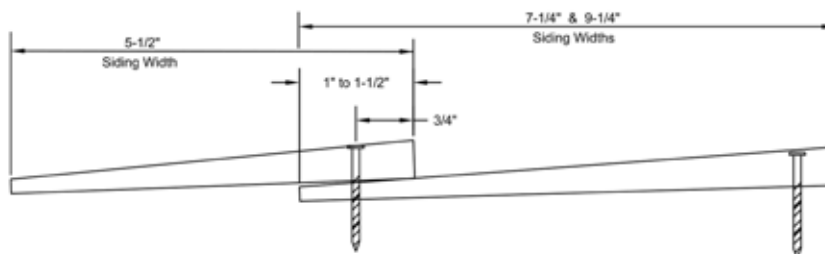
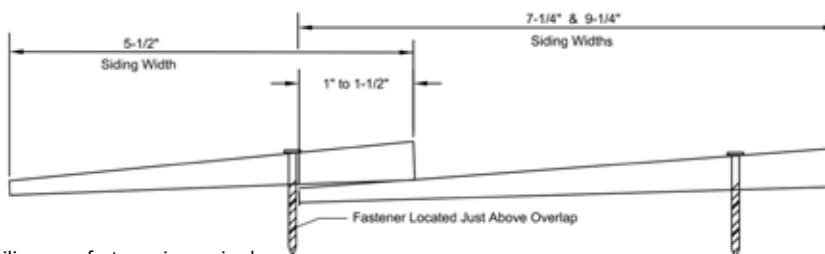
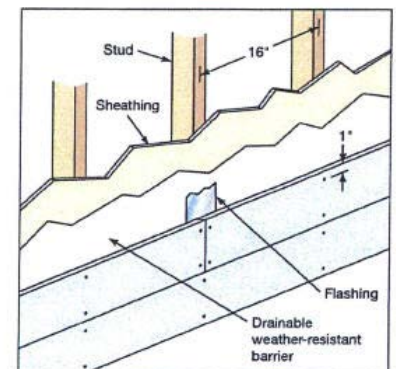

Figure 3: Face Nailing, Option 2



*When Blind Nailing, one fastener is required in the face of the board within 2" of joints, in addition to fasteners in the top of the board.



Preservation of TruExterior Smooth (Subtle Woodgrain) Surface

Several DURATION® siding products with a “smooth” face have a subtle, vertical (direction of board length) “grain” that nicely simulates real wood. This “grain” can easily be sanded off, either intentionally or accidentally by sanding in a circular motion, against the grain, and/or using finer grit sandpaper. The “grain” can be preserved by lightly sanding in the direction of the grain and using a 50-60 grit sandpaper with a sanding block.

To preserve the grain when using fasteners and fillers simply apply a piece of painter’s tape to the face of the board in the direction of the board length, install the fastener through the tape and into the framework, fill the fastener hole with a wood filler, let the filler dry, sand the filler with a 50-60 grit sanding block back and forth in the direction of the painter’s tape, remove the tape and apply two coats of finish paint. Please see images below.

Untouched Board



Tape Applied



1. Apply painter's tape to the face of the board, in the direction of the board length.

Fastener Through Tape



2. Install the fastener through the tape and into the framework.

Filler Applied



3. Fill the fastener hole with exterior wood filler, let the filler dry.

Filler Sanded



4. Sand filler with a 50-60 grit sandpaper with a sanding block. Sand back and forth in the direction of the painter's tape.

Tape Removed



5. Remove tape.

Finish Applied



6. Apply two coats of finish paint.

Inconspicuous Fill



Woven or Mitered Corners

DURATION® Beveled siding can be used to form an outside corner by weaving (one piece overlapping an adjacent piece in alternating fashion) or mitering (each piece meeting at a point on the corner). In either application, a small amount of adhesive and a mechanical fastener can be used at the joint.

Fabrication of these corners is simplified by referring to the saw setting chart provided below.



Compound Miter Saw Settings:

Woven Corners

<u>Siding Size</u>	<u>Woven Left Cross cut setting</u>	<u>Woven Bevel Miter setting</u>	<u>Woven Right Crosscut setting</u>
126DBS	3°	90°	6°
128DBS	2°	90°	4°
588DBS	2°	90°	5°
589DBS	2°	90°	5°
5810DBS	1.5°	90°	4.5°

Mitered Corners

<u>Table setting Cross Cut angle</u>	<u>Bevel Setting Miter</u>
3°	45°
2°	45°
2°	45°
2°	45°
1.5°	45°

Starting with Left Flush to corner