



DURATION® Trim & Siding Storage, Handling, Fastening & Installation Guidelines



The following information offers typical installation techniques when working with DURATION® Trim & Siding. These products should never be used in structural or load bearing applications. These directions are guidelines only. As with installing any building material, care should be taken to adhere to local code requirements and construction best practices, to ensure installation is sufficient for each specific application.

Storage and Handling

For expected performance results, ensure the product is completely dry and clean when fastened to the wall. For proper paint adhesion, the product should be dry and clean before painting.

- DURATION® Trim & Siding must be stored on a flat, level surface in a clean dry location.
- Keep product wrapped and protected from the elements until ready for installation.
- Installing product wet or saturated may result in gapping at joint locations. **GAPPING DOES NOT CONSTITUTE A PRODUCT DEFECT.**

Working with DURATION® Trim & Siding

This product is an excellent replacement for wood trim and siding and can be installed using proven woodworking tools and methods. For ease of use, consider the following before working:

Safety - In working with any product that may cause airborne debris such as a nuisance dust, be sure to take proper measures to protect against eye and inhalation hazards.

Cutting - DURATION® Trim & Siding can be cut using standard sawblades. However, for longer tool life, carbide tipped blades are recommended and should be "dedicated", i.e. only poly-ash material should be cut with those blades.

Routing & Drilling - DURATION® Trim & Siding can be drilled and routed using standard woodworking tools, but carbide tipped router and drill bits are recommended and should be dedicated.

Caulks & Sealants - While DURATION® Trim & Siding does not require priming or sealing of end-cuts, a variety of caulks and sealants may be used in conjunction with the product to help prevent water intrusion into the structure.

Fastening - Standard nail guns and screws can be used to install DURATION® Trim & Siding as it takes a variety of fasteners with ease and does not mushroom at the fastener head.

- Ensure the product is completely dry and clean before fastening to the wall.
- Use fasteners designated for exterior trim and siding.
- Pre-drilling is not required.

Expansion and Contraction - DURATION® Trim & Siding is very stable during periods of temperature and moisture change; all ends can be placed tight to adjoining end. No special precautions, such as, glueing or gapping are necessary to control or limit movement. Minor shrinkage at board ends is not considered a defect. Siding may be installed tightly against trim at the ends of each course.

Nail Holes & Repair - Filling nail and screw holes or repairing any minor damage caused by handling may be done using high-grade acrylic caulk or wood fillers.

Use at Grade - Since DURATION® Trim & Siding is highly resistant to moisture, termite attacks, and won't rot; it is approved for ground contact.

Painting - Painting DURATION® Trim & Siding is a requirement, and failure to do so will void the warranty. As in preparing for any painting project, be sure the surface of the product is free of dirt, debris, or other contaminants prior to paint application.

- Can be painted using any high-grade exterior paint. Make sure to follow the paint manufacturer's application recommendations.
- Can be painted any color without special precaution as the product is not prone to excessive movement due to heat buildup.

(Over)



Trim & Moulding

- Fasteners should be installed every 24" OC or less. For best results, place fasteners within 2" of the edge of each piece.
- Butt joints are to be cut at 30 to 45 degree angles.

Beveled Siding

- Two fasteners are required within 2" of joints - one fastener at the top of the board and one fastener in the face.
- Use of minimum 6d ring shank nails are recommended to meet the windload and performance results stated in the ES report PER-13069.
- Minimum lap is 1".
- The product will accept other types of fasteners including various types of exterior grade nails and screws. Care should be taken to ensure both fastener type and fastening pattern will meet local code requirements and performance needs.
- Standard nail guns can be used to install DURATION® Siding. Nail guns should be adjusted to ensure nail heads are flush with surface. Do not over drive or countersink.

For 2x Applications

- Use a fastener that is long enough to penetrate a solid wood substrate a minimum of 1-1/2".
- Fasteners should penetrate a framing member. Sheathing alone may not provide adequate support or holding power.

Non-Beveled Siding

- Use of 8d x 2-1/2" stainless steel ring shank nails is recommended to meet the windload and performance results states in the ES report PER-13069.
- Use 2 fasteners per every framing member.
- At least one fastener should be run through the face of the profile, simply fastening the product through the tongue is not sufficient.
- Fasteners should be installed every 16" - 24" OC or less to meet the performance results stated in the ES report PER-13069. For best results, place fasteners within 2" of the edge of each board.
- Use a fastener that is long enough to penetrate a solid wood substrate a minimum of 1-1/2".
- Fasteners should penetrate a framing member. Sheathing alone may not provide adequate support or holding power.
- Standard nail guns can be used to install DURATION® Siding. Nail guns should be adjusted to ensure nail head is flush with surface.
- Profiles can be installed both horizontally and vertically. Make sure to adhere to local building codes to ensure that wind load or other fastening requirements are met. For vertical applications, make sure sufficient horizontal blocking is properly installed.

Acceptable Wall Preparation & Fastening Patterns for Beveled Siding

Traditional Framed Walls

- DURATION® Siding must be installed on frame-built walls with studs spaced 16" O.C. or at most 24" O.C.
- The wall may be sheathed with O.S.B. panels depending on local codes. DURATION® Siding must be fastened at the location of the studs.

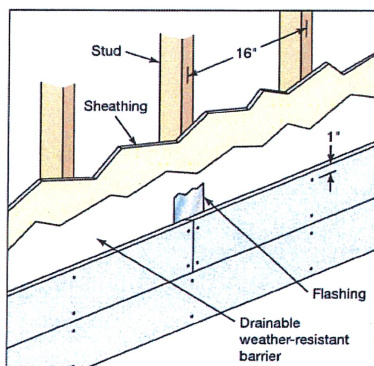

Appropriate color-matched aluminum flashing or 30 lb. felt strips can be used behind all butt joints to reduce water infiltration.

Figure 1: Blind Nailing

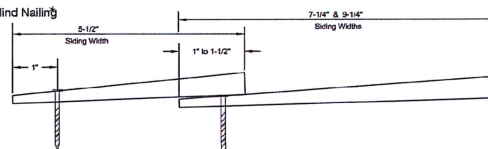

Figure 2: Face Nailing, Option 1

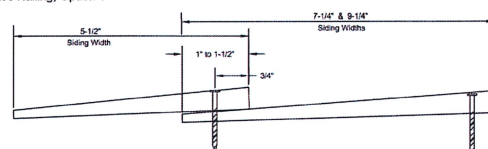
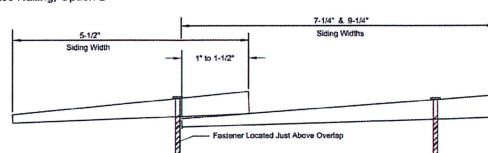

Figure 3: Face Nailing, Option 2



*When Blind Nailing, one fastener is required in the face of the board within 2" of joints, in addition to fasteners in the top of the board.